

Weight adjustment  
50-130 Kg

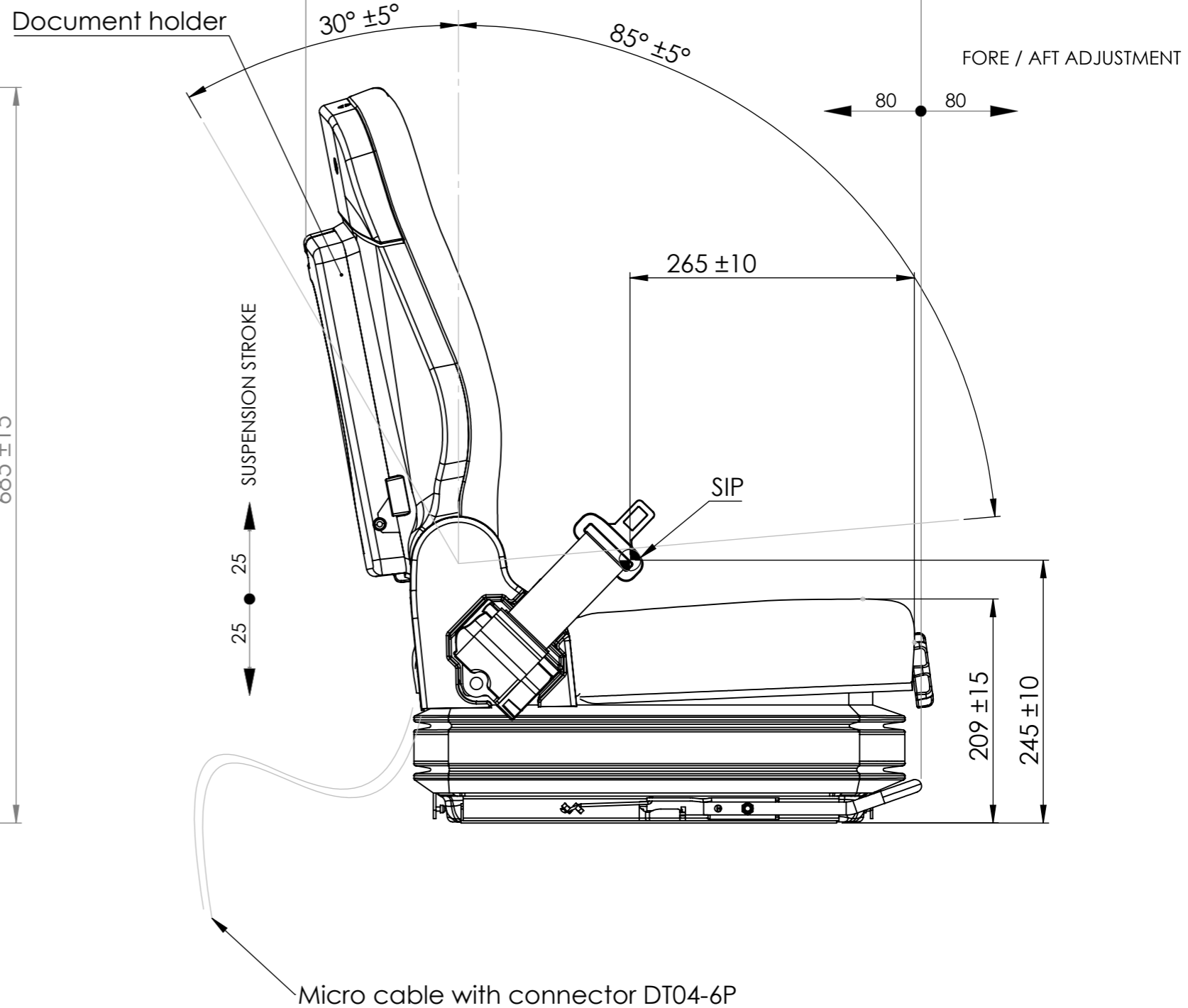
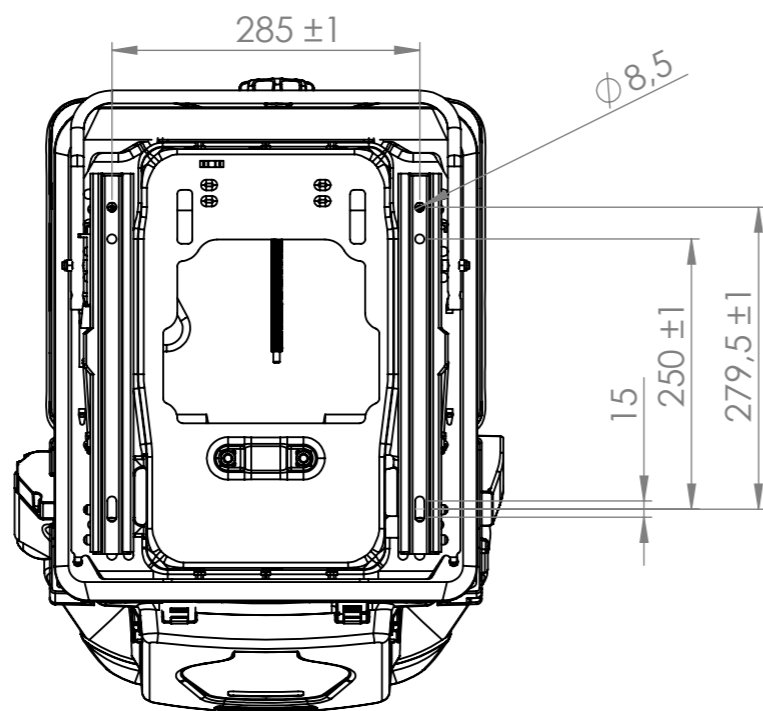

PRE-TRATTAMENTO SUPERF. (1st SURF. TREATMENT)	TRATTAMENTO SUPERF. FINALE (LAST SURF. TREAT.)	QUANTITA' (Q.TY)	RUGOSITA' SUPERF. (SURF. ROUGHN.)
TRATT. TERMICO (HEAT TREATMENT)	PESO GREZZO (RAW W.) (Kg)	PESO FINITO (FINAL W.) (Kg)	FOGLIO (SHEET)

TOLLERANZE GENERALI CARP. (GENERIC CARPENTRY TOLERANCES) : SMUSSI NON QUOT : 1X45° - RAGGI : R0,5 (CHAMFERS WITHOUT TOL : 1 X 45° - FILLETS : R0,5)

CESOIA (SHEARING), PIEGA (BENDING) E OSSITAGLIO (OXYCUTTING) : ± 1 mm - SALDATURA (WELDING) : ± 2 mm - PIEGATURA (BENDING) : ± 1°

DIM LINE ANG (LIN. & ANG. DIM.)	F	FINE	H	GRADO DI PREC. PER QUOTE LINEARI E ANGOLARI SENZA TOLLERANZA SECONDO UNI-EN 22768-1 (PREC. LEVEL FOR LINEAR AND ANGULAR DIMENSIONS WITHOUT TOL. ACCORDING UNI-EN 22768-1)
	M	MEDIA (MEDIUM)	K	
	C	GROSSOLANA (COARSE)	L	GRADO DI PREC. PER TOLLERANZE GEOMETRICHE GENERALI SECONDO UNI-EN 22768-2 (PREC. LEVEL FOR GENERIC GEOMETRIC TOL. ACCORDING UNI-EN 22768-2)
	V	MOLTO GROSSOLANA (VERY COARSE)	-	

DISEGNATO (DRAWN) : Malaguti CONTROLATO (CHKD) : Malaguti	<b>MATERIALE (MATERIAL) :</b> DESCRIZIONE (DESCRIPTION) : <b>SEAT WITH MEC. SUSPENSION + SLIDES + MICRO + SAFETY BELT + DOCUMENT HOLDER + BLACK SKY</b>	<b>A3</b>
<b>SEAT INDUSTRIES</b> CAMPAGNOLA (RE) - ITALY	COD. ATRZ. (TOOL REF.) : -- CODICE (REF.) : <b>SI101102</b>	
DATA (DATE) 04/03/2025	SCALA (SCALE) 1:5	